

THE **PLOUGHMAN**



4

BEDROOMS



3

BATH



3

CAR GARAGE



2845

SF

INCLUDED FEATURES

Covered Entry | Timber Frame Details | Owners' Suite On Main Floor
9' Ceilings On Main Floor | 3 Car Garage | Split Level Back Patio Door
Finished Basement With Family Room | Tray Ceiling In Great Room

OPTIONAL CONSIDERATIONS

Tray Ceiling In Owners' Suite | Upgrade Deck And Patio Slider Off Dining
Metal Roof Accents | Garage Door Windows | Laundry Sink
Built-Ins | Tub In Owners' Suite

THE PLOUGHMAN

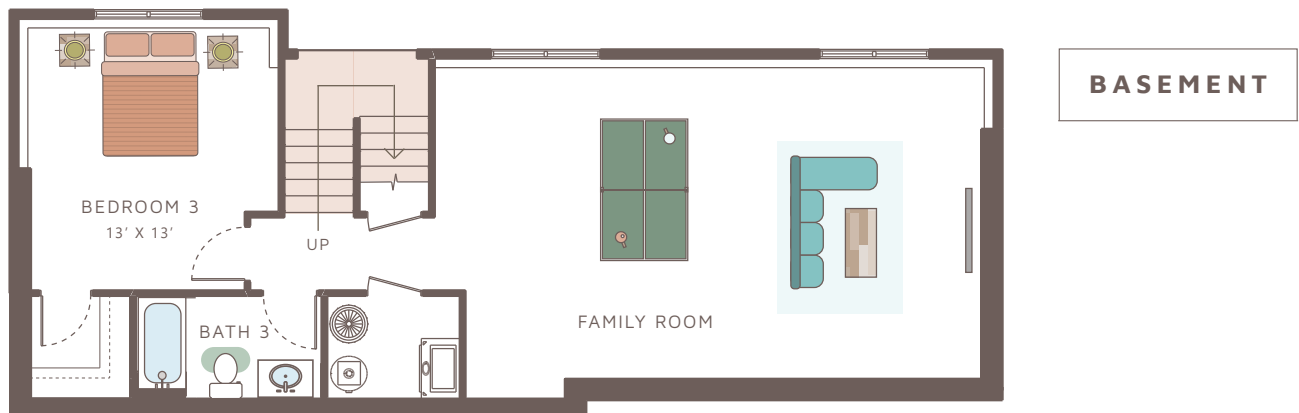

Please note: This is an artist rendering, not drawn to scale. House plans subject to alterations without notice. This plan is the exclusive property of Sussex Construction, Inc. Some items shown are upgrades. LAST UPDATED 10/2022.