

## THE BAXTER

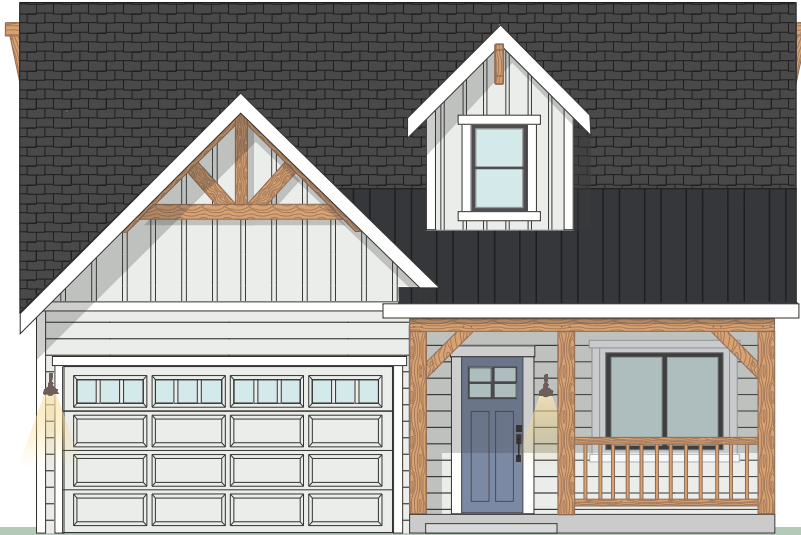

4

BEDROOMS



3

BATH



2

CAR GARAGE



2342

SF

### INCLUDED FEATURES

Large Covered Porches | Timber Frame Details | Owner's Suite On Main Level | 9' Ceilings | 2x6 Exterior Construction | 2 Car Garage

### OPTIONAL CONSIDERATIONS

3rd Car Garage | Tray Ceiling



# THE BAXTER

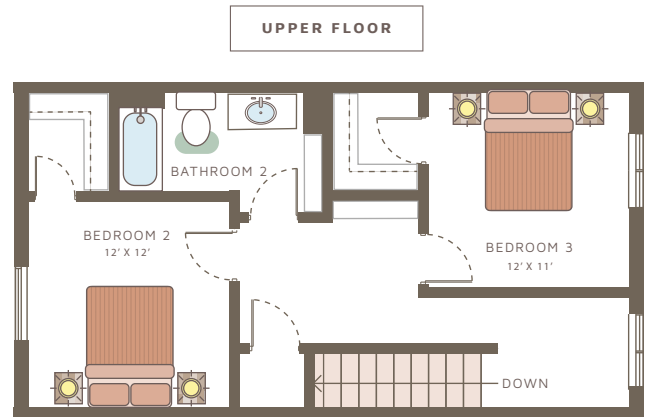

Please note: This is an artist rendering, not drawn to scale. House plans subject to alterations without notice. This plan is the exclusive property of Sussex Construction, Inc. Some items shown are upgrades. LAST UPDATED 6/2022.