

## THE **ELM**



3

BEDROOMS



2.5

BATH



2

CAR GARAGE



2410

SF

### INCLUDED FEATURES

Covered Entry | Timber Frame Details | Master Suite On Upper Floor  
Open-Plan Living | 9' Ceilings | 2 x 6 Exterior Construction | Two-Car Garage

### OPTIONAL CONSIDERATIONS

Upgraded Master Bathroom | Vaulted Master Bedroom Ceiling  
Bonus Room Over Garage | Additional Bay In Garage Adds 360 SF

# THE ELM

MAIN FLOOR



UPPER FLOOR

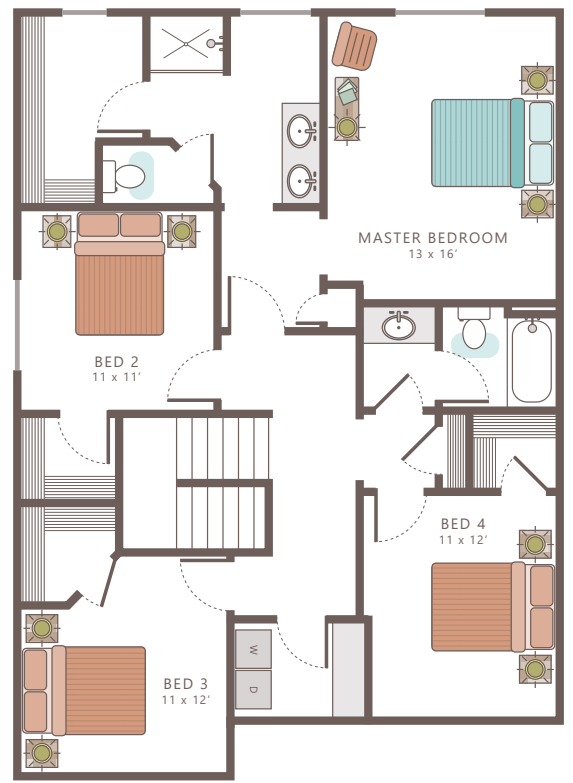

UPGRADE  
BONUS ROOM

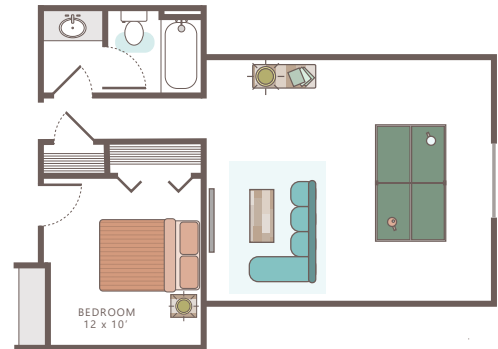

*Please note: This is an artist rendering, not drawn to scale. House plans subject to alterations without notice.  
 This plan is the exclusive property of Sussex Construction, Inc. LAST UPDATED MARCH 2019*